

**ADDENDUM 01 TO THE
CONTRACT DOCUMENTS**

FOR

**COTE BLANCHE BAY HYDROLOGIC RESTORATION
PVC WALL EXTENSION PROJECT
(TV-04)**

ST. MARY PARISH, LOUISIANA



**LOUISIANA
COASTAL PROTECTION AND RESTORATION
AUTHORITY
OPERATIONS BRANCH**

OCTOBER 2014

**ADDENDUM 01 TO THE CONTRACT DOCUMENTS FOR
COTE BLANCHE BAY HYDROLOGIC RESTORATION PVC WALL EXTENSION
PROJECT (TV-04)
ST. MARY PARISH, LOUISIANA**

The clarifications in this addendum supersede the requirements in the Bid Documents dated August 2014

1. QUESTIONS SUBMITTED BY BIDDING CONTRACTORS

A complete list of questions submitted by the bidding contractors and answers to the questions are included in Attachment 1 of this Addendum.

2. REVISIONS TO THE LOUISIANA UNIFORM PUBLIC WORK BID FORM

The Louisiana Uniform Public Work Bid Form has been revised for this project. The revised form is included in Attachment 2 of this Addendum.

3. NON-MANDATORY PRE BID ATTENDANCE RECORD

The attendance record from the non-mandatory pre bid conference is included in Attachment 3 of this Addendum.

4. REVISIONS TO THE TECHNICAL SPECIFICATIONS

The following section is added to the Technical Specifications.

TS-901 RAILINGS, PILINGS, AND SIGN REPLACEMENT

901.1 Scope: The contractor shall furnish all of the materials, labor and equipment necessary to re-install the rail components on the weir structure at the mouth of Mud Bayou, on one side of the weir structure at Bayou Long, and install a timber pile and arrow sign at Humble F Canal in accordance with the Plans and these Specifications, or as directed by the Engineer.

901.2 Fabrication: The replacement rails shall be installed using a ½ inch diameter stainless steel cable that will be secured to the existing sheet pile wall on one end and the existing wooden pile on the other end. Stainless steel cable clips shall be used to secure the cable. The stainless steel cable shall be inserted through a two inch diameter, schedule 40 PVC pipe and wrapped in red reflective tape as shown on the Plans. The remnants of the existing pipe rails shall be removed prior to the installation of the new cable rails and disposed of by the contractor.

The treated timber piles used for the installation of the cable rails and the installation of the sign and Humble F canal shall be CCA treated pine with a minimum of 2.5 pounds per cubic foot of CCA treatment. The piles shall be a minimum of 50 ft. in length with a minimum butt diameter of 12 inches.

The arrow sign to be installed at the Humble F canal shall be fabricated from 1/8 inch thick commercial grade aluminum plate to the dimensions as shown on the Plans. The sign shall be overlaid with white vinyl film. All letters and borders shall be retro-reflective and match the dimensions, colors and sizes shown on the Plans. The film, letters and borders shall be obtained from a USCG qualified supplier.

901.3 Installation: The installation of the new railings on the structures in Mud Bayou and Bayou long will require the installation of treated timber piles to support the cable structure. These shall be installed with the use of a track hoe or other suitable pile driving equipment. The top of these new pilings shall be one foot above the elevation of the existing sheet pile structure at each of these locations. Two pilings will be required at the Mud Bayou structure, one piling will be required at the Bayou Long structure, and one piling will be required at the Humble F Canal. An arrow sign, as shown on the Plans, will be installed on the piling at the Humble F canal. The sign shall be bolted to the new timber piling. After completion of the pile, sign installation, and cable rail installation, the tops of the timber piles shall be trimmed to remove any sharp or jagged edges and covered with a piece of galvanized aluminum flashing as shown on the Plans.

Damaged treated timber piles shall be removed and replaced with new treated timber piles in accordance with direction from the Engineer or Owner.

The arrow sign shall also conform to the regulations in the United States Coast Guard (USCG) Commandant Directives Manuals No. 16500.3 (Series), "Aids to Navigation Manual – Technical" and No. 10360-3 (Series), "Coatings and Color Manual."

901.4 Measurement and Payment: Payment for this item will be made at the contract unit price for Bid Item TS-901, "Railings, Pilings, and Sign Replacement". Measurement shall be on a lump sum basis for this item.

5. CONSTRUCTION DRAWINGS

The complete set of construction drawings for this project is included in Attachment 4. The title sheet has been updated, the summary of estimated quantities has been updated on Sheet 2, an additional source of rock has been added to Sheet 4, and Sheets 7, 8, and 9 are new sheets.

ATTACHMENT 1
QUESTIONS AND ANSWERS

**COTE BLANCHE BAY HYDROLOGIC RESTORATION--PVC WALL EXTENSION
QUESTION AND ANSWER LOG**

No.	QUESTIONS	RESPONSE
1	TS-201 Surveying, paragraph 201.3.2 states: "Flotation channel limits shall be staked as needed for construction. (If necessary)". Is flotation dredging allowed? If so, what is the maximum depth and width, etc.?	Based on the alignment of the PVC wall and the water depths in the project area, no dredging of a flotation channel will be allowed.
2	TS-701 Relocation of Rock, paragraph 701.4 states: "The Engineer may require the Contractor to remove rock or place additional rock as necessary in order to achieve compliance and acceptance." What would be the source of the additional rock?	The source of the additional rock, if needed, is shown on the revised Figure 3 in the project drawings.
3	Do the waler splice plates get coated or galvanized?	No
4	The majority of the hardware is galvanized, except the hardware for the splice plates. Can you confirm the hardware for the waler splice plates is not galvanized?	The waler splice plates are not galvanized.
5	Will imported hardware be allowed, or does the Buy America Act apply to this contract?	All bidders must comply with all applicable state and Federal laws, rules, regulations, and guidelines. Since this Project is funded through a state and Federal cost share, the Buy American Act (41 USC §10, et seq.) is applicable to this Project.
6	TS-301 Wall Assembly Hardware, does not specify a grade for the hardware. Will ASTM A307 grade bolts be acceptable?	ASTM A307 grade bolts will be acceptable for this project.
7	Will you please provide the engineer's cost estimate for the referenced project?	The engineer's cost estimate for this project is \$1,000,000 to \$2,000,000.
8	<p>It appears that the quantities that are listed for the "Splice Plates" and "Splice Plate Bolts" are wrong. This is what I show:</p> <p>Splice Plates Base Bid: 280 ea 1000'/20' = 50x4 = 200 ea 400'/20' = 20x4 = 80 ea 200+80 = 280 ea Alt 1: 40 ea 200'/20' = 10x4 = 40 ea Alt 2: 36 ea 170'/20' = 9x4 = 36 ea Alt 3: 40 ea 200'/20' = 10x4 = 40 ea</p> <p>Based on 20 ft walers Splice Plate Bolts Drawing on figure 6 shows 6 ea per plate Base Bid: 280x6 = 1680 ea Alt 1: 40x6 = 240 ea Alt 2: 36x6 = 216 ea Alt 3: 40x6 = 240 ea</p>	<p>The correct project quantities for the splice plates and splice plate bolts are as follows:</p> <p>Splice Plates Base Bid: 280 ea Alt 1: 44 ea Alt 2: 40 ea Alt 3: 44 ea</p> <p>Splice Plate Bolts Drawing on figure 4 shows 4 ea per plate. Base Bid: 560 ea Alt 1: 88 ea Alt 2: 80 ea Alt 3: 88ea</p>
9	Are the 4x6 walers rough cut or nominal cut?	The walers are nominal cut.
10	Would the CPRA/NRCS consider the placement of new rock in lieu of relocating the existing rock?	No
11	Is there fabric to go under the rock at the new location?	Fabric will not be placed as part of the rock relocation for this project.
12	SP-8 states "Upon request, overnight room and board shall be provided ...". Will this be a request after the contract is signed and will this be paid as a change order to the contract?	No request for overnight room and board is anticipated for this project.
13	SP-10: Is a office for the Engineer/Resident Project Rep really going to be necessary? The base project is only 4 months long.	No office will be necessary for the Engineer or Resident Project Representative.
14	SP-11: Are there any pipelines in the way? Will a "One Call" need to be performed?	A one call will need to be performed. The one call and the results of the magnetometer survey will determine the absence or presence of pipelines in the project area.
15	SP-14: Will an "OCP" or "Builder's Risk" policy be required?	Insurance Requirements are described in SP-14. No Builder's Risk Insurance will be required for this project.
16	TS-201.3: Can you recommend a company in the area of the project that can do the "Magnetometer Survey"?	CPRA and NRCS cannot recommend individuals for the magnetometer survey.
17	TS-301.3 & 401.3: States "Vibrating hammer will not be allowed for installation of the treated pile/vinyl sheet pile", is this a true statement?	A vibrating hammer will be allowed for the installation of the treated timber piles but will not be allowed for the installation of the vinyl sheet piles.
18	TS-801.3: Are the timber pile incidental to the warning signs?	Yes, the timber piles for the warning sign installation are incidental.
19	Can this project be submitted via Central Bidding?	No electronic bidding is provided for this project. Bidders must comply with the bid requirements included in the Advertisement for Bids and the Instructions to Bidders.
20	Other than the Bid Form and Bid Bond, is there any other forms or documents required at bid time?	Bidders must comply with the bid procedure requirements included in the Instructions to Bidders.
21	Where can I get a plan holders list?	The sign in sheet from the non-mandatory pre bid meeting is included in the Addendum.
22	Will the answer to these and other questions be on your web site?	Answers to all questions will be provided in the addendum for this project.
23	I write to ask for approval of SG-325 as a substitute for the SLP-350 sheet pile specified on the Cote Blanche Hydrologic Restoration/School Bus Bayou Project - Wall Extension. I have enclosed a copy of the specification sheet for this sheet pile section which includes all information needed including a drawing, cut section and performance data. By approving this sheet, no additional construction cost would be incurred and the only change to the plans would be to detail sheets 4 and 5 (change the depth dimension from 6.5" to 7"). All steel hardware, walers and piling dimensions would remain the same. Pursuant to the bid specifications, this request is made prior to seven working days before the opening of the bids.	Based on the review of the specification sheet for the SG-325 vinyl sheet (box profile) manufactured by Crane Materials International, the use of this vinyl sheet is approved for this project.
24	Please email or fax me the above mentioned information for the following project(s): Cote Blanche Bay Hydrologic Restoration/PVC Wall Extension - TV04--bidders, plan holders and confirmation of bid date and time.	The sign in sheet from the non-mandatory pre bid meeting is included in the Addendum.
25	Please see the attached spec sheet regarding the EverLast sheet piles. Would these be considered an "approved equal"?	Based on the review of the specification sheet for the ESP 3.5 vinyl sheet pile manufactured by EverLast Synthetic Products, the use of this vinyl sheet is approved for this project.
CLARIFICATIONS		
1	The successful bidder shall provide a certificate of insurance listing Miami Corp as an additional insured with waiver of subrogation in Miami Corp's favor prior to contractor mobilization.	

ATTACHMENT 2

REVISED LOUISIANA UNIFORM PUBLIC WORK BID FORM

LOUISIANA UNIFORM PUBLIC WORK BID FORM

TO: Facility Planning and Control
Claiborne Building
1201 N. Third St., Suite 7-160
Baton Rouge, LA 70802
(Owner to provide name and address of owner)

BID FOR: Cote Blanche Bay
Hydrologic Restoration
PVC Wall Extension
(TV-04)
(Owner to provide name of project and other identifying information)

The undersigned bidder hereby declares and represents that she/he; a) has carefully examined and understands the Bidding Documents, b) has not received, relied on, or based his bid on any verbal instructions contrary to the Bidding Documents or any addenda, c) has personally inspected and is familiar with the project site, and hereby proposes to provide all labor, materials, tools, appliances and facilities as required to perform, in a workmanlike manner, all work and services for the construction and completion of the referenced project, all in strict accordance with the Bidding Documents prepared by: Providence Engineering and Environment Group LLC and dated: June 2014
(Owner to provide name of entity preparing bidding documents.)

Bidders must acknowledge all addenda. The Bidder acknowledges receipt of the following **ADDENDA:** (Enter the number the Designer has assigned to each of the addenda that the Bidder is acknowledging) _____ .

TOTAL BASE BID: For all work required by the Bidding Documents (including any and all unit prices designated "Base Bid" * but not alternates) the sum of:
_____ Dollars (\$ _____)

ALTERNATES: For any and all work required by the Bidding Documents for Alternates including any and all unit prices designated as alternates in the unit price description.

Alternate No. 1 Add 200 Linear Feet of Wall Extension for the lump sum of:
_____ Dollars (\$ _____)

Alternate No. 2 Add 170 Linear Feet of Wall Extension for the lump sum of:
_____ Dollars (\$ _____)

Alternate No. 3 Add 200 Linear Feet of Wall Extension for the lump sum of:
_____ Dollars (\$ _____)

NAME OF BIDDER: _____

ADDRESS OF BIDDER: _____

LOUISIANA CONTRACTOR'S LICENSE NUMBER: _____

NAME OF AUTHORIZED SIGNATORY OF BIDDER: _____

TITLE OF AUTHORIZED SIGNATORY OF BIDDER: _____

SIGNATURE OF AUTHORIZED SIGNATORY OF BIDDER **: _____

DATE: _____

* The Unit Price Form shall be used if the contract includes unit prices. Otherwise it is not required and need not be included with the form. The number of unit prices that may be included is not limited and additional sheets may be included if needed.

** If someone other than a corporate officer signs for the Bidder/Contractor, a copy of a corporate resolution or other signature authorization shall be required for submission of bid. Failure to include a copy of the appropriate signature authorization, if required, may result in the rejection of the bid unless bidder has complied with La. R.S. 38:2212(A)(1)(c) or RS 38:2212(O) .

BID SECURITY in the form of a bid bond, certified check or cashier's check as prescribed by LA RS 38:2218.A is attached to and made a part of this bid.

LOUISIANA UNIFORM PUBLIC WORK BID FORM

UNIT PRICE FORM

TO: FACILITY PLANNING AND CONTROL
CLAIBORNE BUILDING
1201 N. THIRD ST., SUITE 7-160
BATON ROUGE, LA 70802

(Owner to provide name and address of owner)

BID FOR: COTE BLANCHE BAY
HYDROLOGIC RESTORATION
PVC WALL EXTENSION
(TV-04)

(Owner to provide name of project and other identifying information)

UNIT PRICES: This form shall be used for any and all work required by the Bidding Documents and described as unit prices. Amounts shall be stated in figures and only in figures.

DESCRIPTION: <input checked="" type="checkbox"/> Base Bid or <input type="checkbox"/> Alt.# ___ MOBILIZATION & DEMOBILIZATION				
REF. NO.	QUANTITY:	UNIT OF MEASURE:	UNIT PRICE	UNIT PRICE EXTENSION (<i>Quantity times Unit Price</i>)
TS-101	1	LUMP SUM		

DESCRIPTION: <input checked="" type="checkbox"/> Base Bid or <input type="checkbox"/> Alt.# ___ TREATED TIMBER PILES				
REF. NO.	QUANTITY:	UNIT OF MEASURE:	UNIT PRICE	UNIT PRICE EXTENSION (<i>Quantity times Unit Price</i>)
TS-301	206	EACH		

DESCRIPTION: <input checked="" type="checkbox"/> Base Bid or <input type="checkbox"/> Alt.# ___ 20' VINYL SHEET PILE				
REF. NO.	QUANTITY:	UNIT OF MEASURE:	UNIT PRICE	UNIT PRICE EXTENSION (<i>Quantity times Unit Price</i>)
TS-401	1,264	EACH		

DESCRIPTION: <input checked="" type="checkbox"/> Base Bid or <input type="checkbox"/> Alt.# ___ 16' VINYL SHEET PILE				
REF. NO.	QUANTITY:	UNIT OF MEASURE:	UNIT PRICE	UNIT PRICE EXTENSION (<i>Quantity times Unit Price</i>)
TS-401	136	EACH		

DESCRIPTION: <input checked="" type="checkbox"/> Base Bid or <input type="checkbox"/> Alt.# ___ WOODEN WALERS				
REF. NO.	QUANTITY:	UNIT OF MEASURE:	UNIT PRICE	UNIT PRICE EXTENSION (<i>Quantity times Unit Price</i>)
TS-501	2,800	LINEAR FOOT		

DESCRIPTION: <input checked="" type="checkbox"/> Base Bid or <input type="checkbox"/> Alt.# ___ WALER SPLICE PLATES				
REF. NO.	QUANTITY:	UNIT OF MEASURE:	UNIT PRICE	UNIT PRICE EXTENSION (<i>Quantity times Unit Price</i>)
TS-601	280	EACH		

DESCRIPTION: <input checked="" type="checkbox"/> Base Bid or <input type="checkbox"/> Alt.# ___ SPLICE PLATE BOLTS				
REF. NO.	QUANTITY:	UNIT OF MEASURE:	UNIT PRICE	UNIT PRICE EXTENSION (<i>Quantity times Unit Price</i>)
TS-601	560	EACH		

DESCRIPTION: <input checked="" type="checkbox"/> Base Bid or <input type="checkbox"/> Alt.# ___ 5" BOLT				
REF. NO.	QUANTITY:	UNIT OF MEASURE:	UNIT PRICE	UNIT PRICE EXTENSION (<i>Quantity times Unit Price</i>)
TS-601	2,528	EACH		

Wording for "DESCRIPTION" is to be provided by the Owner.
All quantities are estimated. The contractor will be paid based upon actual quantities as verified by the Owner.

LOUISIANA UNIFORM PUBLIC WORK BID FORM

UNIT PRICE FORM

TO: FACILITY PLANNING AND CONTROL

BID FOR: COTE BLANCHE BAY

 CLAIBORNE BUILDING
 1201 N. THIRD ST., SUITE 7-160
 BATON ROUGE, LA 70802

 HYDROLOGIC RESTORATION
 PVC WALL EXTENSION
 (TV-04)

(Owner to provide name and address of owner)

(Owner to provide name of project and other identifying information)

UNIT PRICES: This form shall be used for any and all work required by the Bidding Documents and described as unit prices. Amounts shall be stated in figures and only in figures.

DESCRIPTION: <input checked="" type="checkbox"/> Base Bid or <input type="checkbox"/> Alt.# ___ 36" PILE BOLT				
REF. NO.	QUANTITY:	UNIT OF MEASURE:	UNIT PRICE	UNIT PRICE EXTENSION (<i>Quantity times Unit Price</i>)
TS-601	410	EACH		

DESCRIPTION: <input checked="" type="checkbox"/> Base Bid or <input type="checkbox"/> Alt.# ___ 18" WALER BOLT				
REF. NO.	QUANTITY:	UNIT OF MEASURE:	UNIT PRICE	UNIT PRICE EXTENSION (<i>Quantity times Unit Price</i>)
TS-601	200	EACH		

DESCRIPTION: <input checked="" type="checkbox"/> Base Bid or <input type="checkbox"/> Alt.# ___ ROCK RELOCATION				
REF. NO.	QUANTITY:	UNIT OF MEASURE:	UNIT PRICE	UNIT PRICE EXTENSION (<i>Quantity times Unit Price</i>)
TS-701	1	LUMP SUM		

DESCRIPTION: <input checked="" type="checkbox"/> Base Bid or <input type="checkbox"/> Alt.# ___ PERMANENT WARNING SIGNS				
REF. NO.	QUANTITY:	UNIT OF MEASURE:	UNIT PRICE	UNIT PRICE EXTENSION (<i>Quantity times Unit Price</i>)
TS-801	2	EACH		

DESCRIPTION: <input checked="" type="checkbox"/> Base Bid or <input type="checkbox"/> Alt.# ___ RAILINGS, PILINGS, AND SIGN REPLACEMENT				
REF. NO.	QUANTITY:	UNIT OF MEASURE:	UNIT PRICE	UNIT PRICE EXTENSION (<i>Quantity times Unit Price</i>)
TS-901	1	EACH		

DESCRIPTION: <input type="checkbox"/> Base Bid or <input checked="" type="checkbox"/> Alt.# <u>1</u> TREATED TIMBER PILES				
REF. NO.	QUANTITY:	UNIT OF MEASURE:	UNIT PRICE	UNIT PRICE EXTENSION (<i>Quantity times Unit Price</i>)
TS-301	29	EACH		

DESCRIPTION: <input type="checkbox"/> Base Bid or <input checked="" type="checkbox"/> Alt.# <u>1</u> 20' VINYL SHEET PILE				
REF. NO.	QUANTITY:	UNIT OF MEASURE:	UNIT PRICE <input type="checkbox"/>	UNIT PRICE EXTENSION (<i>Quantity times Unit Price</i>)
TS-401	180	EACH		

DESCRIPTION: <input type="checkbox"/> Base Bid or <input checked="" type="checkbox"/> Alt.# <u>1</u> 16' VINYL SHEET PILE				
REF. NO.	QUANTITY:	UNIT OF MEASURE:	UNIT PRICE <input type="checkbox"/>	UNIT PRICE EXTENSION (<i>Quantity times Unit Price</i>)
TS-401	20	EACH		

Wording for "DESCRIPTION" is to be provided by the Owner.
All quantities are estimated. The contractor will be paid based upon actual quantities as verified by the Owner.

LOUISIANA UNIFORM PUBLIC WORK BID FORM

UNIT PRICE FORM

TO: FACILITY PLANNING AND CONTROL
CLAIBORNE BUILDING
1201 N. THIRD ST., SUITE 7-160
BATON ROUGE, LA 70802

(Owner to provide name and address of owner)

BID FOR: COTE BLANCHE BAY
HYDROLOGIC RESTORATION
PVC WALL EXTENSION
(TV-04)

(Owner to provide name of project and other identifying information)

UNIT PRICES: This form shall be used for any and all work required by the Bidding Documents and described as unit prices. Amounts shall be stated in figures and only in figures.

DESCRIPTION:	<input type="checkbox"/> Base Bid or <input checked="" type="checkbox"/> Alt.# <u>1</u> WOODEN WALERS			
REF. NO.	QUANTITY:	UNIT OF MEASURE:	UNIT PRICE	UNIT PRICE EXTENSION <i>(Quantity times Unit Price)</i>
TS-501	400	LINEAR FOOT		

DESCRIPTION:	<input type="checkbox"/> Base Bid or <input checked="" type="checkbox"/> Alt.# <u>1</u> WALER SPLICE PLATES			
REF. NO.	QUANTITY:	UNIT OF MEASURE:	UNIT PRICE	UNIT PRICE EXTENSION <i>(Quantity times Unit Price)</i>
TS-601	44	EACH		

DESCRIPTION:	<input type="checkbox"/> Base Bid or <input checked="" type="checkbox"/> Alt.# <u>1</u> SPLICE PLATE BOLTS			
REF. NO.	QUANTITY:	UNIT OF MEASURE:	UNIT PRICE	UNIT PRICE EXTENSION <i>(Quantity times Unit Price)</i>
TS-601	88	EACH		

DESCRIPTION:	<input type="checkbox"/> Base Bid or <input checked="" type="checkbox"/> Alt.# <u>1</u> 5" BOLT			
REF. NO.	QUANTITY:	UNIT OF MEASURE:	UNIT PRICE	UNIT PRICE EXTENSION <i>(Quantity times Unit Price)</i>
TS-601	360	EACH		

DESCRIPTION:	<input type="checkbox"/> Base Bid or <input checked="" type="checkbox"/> Alt.# <u>1</u> 36" PILE BOLT			
REF. NO.	QUANTITY:	UNIT OF MEASURE:	UNIT PRICE	UNIT PRICE EXTENSION <i>(Quantity times Unit Price)</i>
TS-601	58	EACH		

DESCRIPTION:	<input type="checkbox"/> Base Bid or <input checked="" type="checkbox"/> Alt.# <u>1</u> 18" WALER BOLT			
REF. NO.	QUANTITY:	UNIT OF MEASURE:	UNIT PRICE	UNIT PRICE EXTENSION <i>(Quantity times Unit Price)</i>
TS-601	28	EACH		

DESCRIPTION:	<input type="checkbox"/> Base Bid or <input checked="" type="checkbox"/> Alt.# <u>2</u> TREATED TIMBER PILES			
REF. NO.	QUANTITY:	UNIT OF MEASURE:	UNIT PRICE	UNIT PRICE EXTENSION <i>(Quantity times Unit Price)</i>
TS-301	25	EACH		

DESCRIPTION:	<input type="checkbox"/> Base Bid or <input checked="" type="checkbox"/> Alt.# <u>2</u> 20' VINYL SHEET PILE			
REF. NO.	QUANTITY:	UNIT OF MEASURE:	UNIT PRICE	UNIT PRICE EXTENSION <i>(Quantity times Unit Price)</i>
TS-401	154	EACH		

Wording for "DESCRIPTION" is to be provided by the Owner.
All quantities are estimated. The contractor will be paid based upon actual quantities as verified by the Owner.

LOUISIANA UNIFORM PUBLIC WORK BID FORM

UNIT PRICE FORM

TO: FACILITY PLANNING AND CONTROL
 CLAIBORNE BUILDING
 1201 N. THIRD ST., SUITE 7-160
 BATON ROUGE, LA 70802
 (Owner to provide name and address of owner)

BID FOR: COTE BLANCHE BAY
 HYDROLOGIC RESTORATION
 PVC WALL EXTENSION
 (TV-04)
 (Owner to provide name of project and other identifying information)

UNIT PRICES: This form shall be used for any and all work required by the Bidding Documents and described as unit prices. Amounts shall be stated in figures and only in figures.

DESCRIPTION:	<input type="checkbox"/> Base Bid or <input checked="" type="checkbox"/> Alt.# <u>2</u> 16' VINYL SHEET PILE			
REF. NO.	QUANTITY:	UNIT OF MEASURE:	UNIT PRICE	UNIT PRICE EXTENSION (<i>Quantity times Unit Price</i>)
TS-401	16	EACH		

DESCRIPTION:	<input type="checkbox"/> Base Bid or <input checked="" type="checkbox"/> Alt.# <u>2</u> WOODEN WALERS			
REF. NO.	QUANTITY:	UNIT OF MEASURE:	UNIT PRICE	UNIT PRICE EXTENSION (<i>Quantity times Unit Price</i>)
TS-501	340	LINEAR FOOT		

DESCRIPTION:	<input type="checkbox"/> Base Bid or <input checked="" type="checkbox"/> Alt.# <u>2</u> WALER SPLICE PLATES			
REF. NO.	QUANTITY:	UNIT OF MEASURE:	UNIT PRICE	UNIT PRICE EXTENSION (<i>Quantity times Unit Price</i>)
TS-601	40	EACH		

DESCRIPTION:	<input type="checkbox"/> Base Bid or <input checked="" type="checkbox"/> Alt.# <u>2</u> SPLICE PLATE BOLTS			
REF. NO.	QUANTITY:	UNIT OF MEASURE:	UNIT PRICE	UNIT PRICE EXTENSION (<i>Quantity times Unit Price</i>)
TS-601	80	EACH		

DESCRIPTION:	<input type="checkbox"/> Base Bid or <input checked="" type="checkbox"/> Alt.# <u>2</u> 5" BOLT			
REF. NO.	QUANTITY:	UNIT OF MEASURE:	UNIT PRICE	UNIT PRICE EXTENSION (<i>Quantity times Unit Price</i>)
TS-601	308	EACH		

DESCRIPTION:	<input type="checkbox"/> Base Bid or <input checked="" type="checkbox"/> Alt.# <u>2</u> 36" PILE BOLT			
REF. NO.	QUANTITY:	UNIT OF MEASURE:	UNIT PRICE	UNIT PRICE EXTENSION (<i>Quantity times Unit Price</i>)
TS-601	50	EACH		

DESCRIPTION:	<input type="checkbox"/> Base Bid or <input checked="" type="checkbox"/> Alt.# <u>2</u> 18" WALER BOLT			
REF. NO.	QUANTITY:	UNIT OF MEASURE:	UNIT PRICE	UNIT PRICE EXTENSION (<i>Quantity times Unit Price</i>)
TS-601	24	EACH		

DESCRIPTION:	<input type="checkbox"/> Base Bid or <input checked="" type="checkbox"/> Alt.# <u>3</u> TREATED TIMBER PILES			
REF. NO.	QUANTITY:	UNIT OF MEASURE:	UNIT PRICE	UNIT PRICE EXTENSION (<i>Quantity times Unit Price</i>)
TS-301	29	EACH		

Wording for "DESCRIPTION" is to be provided by the Owner.
All quantities are estimated. The contractor will be paid based upon actual quantities as verified by the Owner..

LOUISIANA UNIFORM PUBLIC WORK BID FORM

UNIT PRICE FORM

TO: FACILITY PLANNING AND CONTROL
CLAIBORNE BUILDING
1201 N. THIRD ST., SUITE 7-160
BATON ROUGE, LA 70802

(Owner to provide name and address of owner)

BID FOR: COTE BLANCHE BAY
HYDROLOGIC RESTORATION
PVC WALL EXTENSION
(TV-04)

(Owner to provide name of project and other identifying information)

UNIT PRICES: This form shall be used for any and all work required by the Bidding Documents and described as unit prices. Amounts shall be stated in figures and only in figures.

DESCRIPTION: <input type="checkbox"/> Base Bid or <input checked="" type="checkbox"/> Alt.# <u>3</u> 20' VINYL SHEET PILE				
REF. NO.	QUANTITY:	UNIT OF MEASURE:	UNIT PRICE	UNIT PRICE EXTENSION (<i>Quantity times Unit Price</i>)
TS-401	180	EACH		

DESCRIPTION: <input type="checkbox"/> Base Bid or <input checked="" type="checkbox"/> Alt.# <u>3</u> 16' VINYL SHEET PILE				
REF. NO.	QUANTITY:	UNIT OF MEASURE:	UNIT PRICE	UNIT PRICE EXTENSION (<i>Quantity times Unit Price</i>)
TS-401	20	EACH		

DESCRIPTION: <input type="checkbox"/> Base Bid or <input checked="" type="checkbox"/> Alt.# <u>3</u> WOODEN WALERS				
REF. NO.	QUANTITY:	UNIT OF MEASURE:	UNIT PRICE	UNIT PRICE EXTENSION (<i>Quantity times Unit Price</i>)
TS-501	400	LINEAR FOOT		

DESCRIPTION: <input type="checkbox"/> Base Bid or <input checked="" type="checkbox"/> Alt.# <u>3</u> WALER SPLICE PLATES				
REF. NO.	QUANTITY:	UNIT OF MEASURE:	UNIT PRICE	UNIT PRICE EXTENSION (<i>Quantity times Unit Price</i>)
TS-601	44	EACH		

DESCRIPTION: <input type="checkbox"/> Base Bid or <input checked="" type="checkbox"/> Alt.# <u>3</u> SPLICE PLATE BOLTS				
REF. NO.	QUANTITY:	UNIT OF MEASURE:	UNIT PRICE	UNIT PRICE EXTENSION (<i>Quantity times Unit Price</i>)
TS-601	88	EACH		

DESCRIPTION: <input type="checkbox"/> Base Bid or <input checked="" type="checkbox"/> Alt.# <u>3</u> 5" BOLT				
REF. NO.	QUANTITY:	UNIT OF MEASURE:	UNIT PRICE	UNIT PRICE EXTENSION (<i>Quantity times Unit Price</i>)
TS-601	360	EACH		

DESCRIPTION: <input type="checkbox"/> Base Bid or <input checked="" type="checkbox"/> Alt.# <u>3</u> 36" PILE BOLT				
REF. NO.	QUANTITY:	UNIT OF MEASURE:	UNIT PRICE	UNIT PRICE EXTENSION (<i>Quantity times Unit Price</i>)
TS-601	58	EACH		

DESCRIPTION: <input type="checkbox"/> Base Bid or <input checked="" type="checkbox"/> Alt.# <u>3</u> 18" WALER BOLT				
REF. NO.	QUANTITY:	UNIT OF MEASURE:	UNIT PRICE	UNIT PRICE EXTENSION (<i>Quantity times Unit Price</i>)
TS-601	28	EACH		

Wording for "DESCRIPTION" is to be provided by the Owner.
All quantities are estimated. The contractor will be paid based upon actual quantities as verified by the Owner.

LOUISIANA UNIFORM PUBLIC WORK BID FORM

UNIT PRICE FORM

TO: FACILITY PLANNING AND CONTROL
CLAIBORNE BUILDING
1201 N. THIRD ST., SUITE 7-160
BATON ROUGE, LA 70802

(Owner to provide name and address of owner)

BID FOR: COTE BLANCHE BAY
HYDROLOGIC RESTORATION
PVC WALL EXTENSION
(TV-04)

(Owner to provide name of project and other identifying information)

UNIT PRICES: This form shall be used for any and all work required by the Bidding Documents and described as unit prices. Amounts shall be stated in figures and only in figures.

DESCRIPTION:	<input type="checkbox"/> Base Bid or <input checked="" type="checkbox"/> Alt.# <u>3</u> PERMANENT WARNING SIGN			
REF. NO.	QUANTITY:	UNIT OF MEASURE:	UNIT PRICE	UNIT PRICE EXTENSION (<i>Quantity times Unit Price</i>)
TS-801	1	EACH		

DESCRIPTION:	<input type="checkbox"/> Base Bid or <input type="checkbox"/> Alt.# <u>NOT APPLICABLE</u>			
REF. NO.	QUANTITY:	UNIT OF MEASURE:	UNIT PRICE	UNIT PRICE EXTENSION (<i>Quantity times Unit Price</i>)
NOT APPLICABLE	NOT APPLICABLE	NOT APPLICABLE		

DESCRIPTION:	<input type="checkbox"/> Base Bid or <input type="checkbox"/> Alt.# <u>NOT APPLICABLE</u>			
REF. NO.	QUANTITY:	UNIT OF MEASURE:	UNIT PRICE	UNIT PRICE EXTENSION (<i>Quantity times Unit Price</i>)
NOT APPLICABLE	NOT APPLICABLE	NOT APPLICABLE		

DESCRIPTION:	<input type="checkbox"/> Base Bid or <input type="checkbox"/> Alt.# <u>NOT APPLICABLE</u>			
REF. NO.	QUANTITY:	UNIT OF MEASURE:	UNIT PRICE	UNIT PRICE EXTENSION (<i>Quantity times Unit Price</i>)
NOT APPLICABLE	NOT APPLICABLE	NOT APPLICABLE		

DESCRIPTION:	<input type="checkbox"/> Base Bid or <input type="checkbox"/> Alt.# <u>NOT APPLICABLE</u>			
REF. NO.	QUANTITY:	UNIT OF MEASURE:	UNIT PRICE	UNIT PRICE EXTENSION (<i>Quantity times Unit Price</i>)
NOT APPLICABLE	NOT APPLICABLE	NOT APPLICABLE		

DESCRIPTION:	<input type="checkbox"/> Base Bid or <input type="checkbox"/> Alt.# <u>NOT APPLICABLE</u>			
REF. NO.	QUANTITY:	UNIT OF MEASURE:	UNIT PRICE	UNIT PRICE EXTENSION (<i>Quantity times Unit Price</i>)
NOT APPLICABLE	NOT APPLICABLE	NOT APPLICABLE		

DESCRIPTION:	<input type="checkbox"/> Base Bid or <input type="checkbox"/> Alt.# <u>NOT APPLICABLE</u>			
REF. NO.	QUANTITY:	UNIT OF MEASURE:	UNIT PRICE	UNIT PRICE EXTENSION (<i>Quantity times Unit Price</i>)
NOT APPLICABLE	NOT APPLICABLE	NOT APPLICABLE		

DESCRIPTION:	<input type="checkbox"/> Base Bid or <input type="checkbox"/> Alt.# <u>NOT APPLICABLE</u>			
REF. NO.	QUANTITY:	UNIT OF MEASURE:	UNIT PRICE	UNIT PRICE EXTENSION (<i>Quantity times Unit Price</i>)
NOT APPLICABLE	NOT APPLICABLE	NOT APPLICABLE		

Wording for "DESCRIPTION" is to be provided by the Owner.
All quantities are estimated. The contractor will be paid based upon actual quantities as verified by the Owner.

ATTACHMENT 3

NON-MANDADORY PRE BID ATTENDANCE RECORD

NON-MANDATORY PRE-BID CONFERENCE
ATTENDANCE RECORD

DATE: SEPTEMBER 23, 2014 10:00 AM

PROJECT: Cote Blanche Bay Hydrologic Restoration PVC Wall Extension Project (TV-04)

AGENCY: CPRA

PLEASE PRINT CLEARLY

NAME	COMPANY/ADDRESS	PHONE NO.	FAX NO. and E-MAIL
Ben LeBlanc	LeBlanc Marine, LLC P.O. Box 9959 New Iberia, La 70562	337-364-4701	benleblanc@leblancmarine.com
Cory BIELSTEIN	LEA CONTRACTING COMPANY 100 SIMS RD. HATTIESBURG MS 39401	601-264-2100	CBIELSTEIN@LANDCONTRACTING.COM
JIM H. PELLEGRIN	128 WEST WOODLAWN RANCH RD HOUMA, LA. 70363	985-876-3807 " 991-0907	jimfrisco@bellsouth.net
Wade Dupre	128 W. Wood Lawn Ranch Rd Houma, La. 70363	985-876-3807 Cell# 337-303-6950	wadefrisco@bellsouth.net F# 985-876-3174
Gary Duhon	920 Willard St. Morgan City, La Larry Driven Inc.	985-202-1171 985-637-2892	jaggs@bellsouth.net

NON-MANDATORY PRE-BID CONFERENCE
ATTENDANCE RECORD

DATE: SEPTEMBER 23, 2014 10:00 AM

PROJECT: Cote Blanche Bay Hydrologic Restoration PVC Wall Extension Project (TV-04)

AGENCY: CPRA

PLEASE PRINT CLEARLY

NAME	COMPANY/ADDRESS	PHONE NO.	FAX NO. and E-MAIL
Austin Baker	ORION Marine Group Lake Charles, LA	337-302-7496	Abaker@orionmarinegroup.com
Rannal Johnson	CATUN MARITIME Abbeville, LA	337-893-3686	rannaljohnson@catunusa.com
Terry Songy / Jono Songy	PROFESSIONAL CONSTRUCTION SERVICES PCS - N.O., LA	504-467-1444	TERRY.SONGY@PCSBuilds.com JONO.SONGY@PCSBuilds.com
KEN LABAY	Fenstermaker 136 Regency Square Lafayette, LA 70508	337-237-2200	ken@fenstermaker.com
William Lukasko	Fenstermaker 135 Regency Square Lafayette, LA 70508	337-237-2200	337-232-3299 bill@fenstermaker.com

**NON-MANDATORY PRE-BID CONFERENCE
ATTENDANCE RECORD**

DATE: SEPTEMBER 23, 2014 10:00 AM

PROJECT: Cote Blanche Bay Hydrologic Restoration PVC Wall Extension Project (TV-04)

AGENCY: CPRA

PLEASE PRINT CLEARLY

NAME	COMPANY/ADDRESS	PHONE NO.	FAX NO. and E-MAIL
Timmy Couvillion	Couvillion Group 371 Walker Rd Belle Chasse, LA 70037	P (504) 656-8234 C. (504) 329-6104	(504) 656-8235 CG@Couvilliongrp.com TCouvillion@Couvilliongrp.com
Tyler Ray	Wilec Marsh Buggies 1304 Marquette Ave Harvey, LA 70058	337-945-8301	504-341-8487 tyler@wilecmarshbuggies.com tray@wilecmarshbuggies.com
Chad Couville	309 La Rue France, Suite 201 Lafayette, LA 70508	337.264.1695	337.264.9499 ccouville@miami-group.com
Nathan Dondis	P.O. Box 967 Lake Arthur, LA 70549	337-540-8313	337-205-8519 NATHANDONDIS@BSMARINESERVICES.COM
CHRIS FRANCIOSI	PO BOX 10582 NEW ORLEANS LA 70181	504 835 0303	NOLANS@BERTUCCICORP.COM CHRISF@BERTUCCICORP.COM

**NON-MANDATORY PRE-BID CONFERENCE
ATTENDANCE RECORD**

DATE: SEPTEMBER 23, 2014 10:00 AM

PROJECT: Cote Blanche Bay Hydrologic Restoration PVC Wall Extension Project (TV-04)

AGENCY: CPRA

PLEASE PRINT CLEARLY

NAME	COMPANY/ADDRESS	PHONE NO.	FAX NO. and E-MAIL
Eric Braux	Dolphin Services Houma LA 70362	318-243-9972	ebraux@gifinc.com
Gary Leonard Lowell Hebert	Providence 1701 Main St. B.H. La 70807	(225) 766-7400	gary.leonard@providenceeng.com lowell.hebert@providenceeng.com

ATTACHMENT 4
CONSTRUCTION DRAWINGS

STATE OF LOUISIANA
 COASTAL PROTECTION AND RESTORATION AUTHORITY
 OPERATIONS DIVISION

INDEX TO SHEETS

SHEET NO.	DESCRIPTION
1	TITLE SHEET
2	GENERAL NOTES & ESTIMATED QUANTITIES
3	PLAN VIEW
4	DETAILS
5	DETAILS
6	WARNING SIGN DETAILS
7	SIGN PLACEMENT AND RAILING OVERALL PLAN VIEW
8	SIGN AND RAILING PLACEMENT
9	DETAIL SHEET

COTE BLANCHE HYDROLOGIC RESTORATION
 SCHOOL BUS BAYOU PROJECT - WALL EXTENSION
 TV-04
 ST. MARY PARISH, LOUISIANA

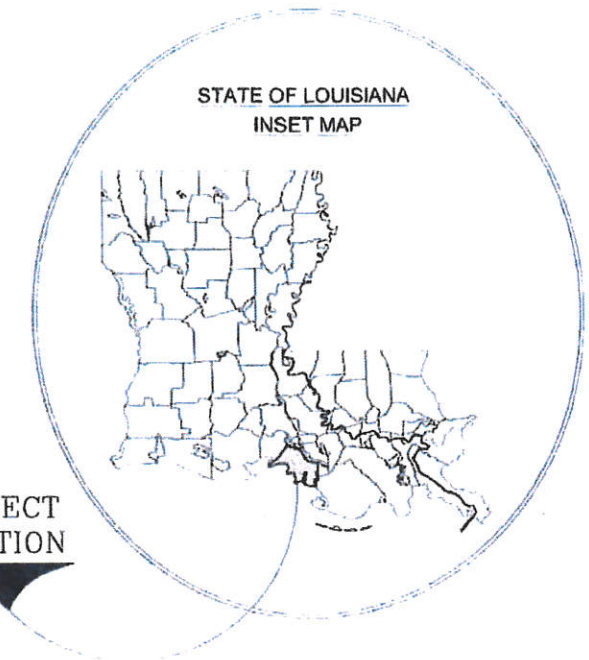

PROJECT
 LOCATION

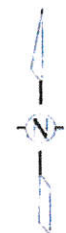

[Signature]
 CHIEF, ENGINEERING DIVISION

[Signature]
 CHIEF, OPERATIONS DIVISION

Patrick Landry
 REGIONAL MANAGER, OPERATIONS DIVISION

[Signature] FOR STAN AULCOIN
 CONSTRUCTION MANAGER, OPERATIONS DIVISION

[Signature]
 CONSULTANT PROJECT ENGINEER



FEDERAL
 PROJECT
 SPONSOR



STATE
 PROJECT
 SPONSOR



TYPE OF CONSTRUCTION
 CLASSIFICATION III (HEAVY CONSTRUCTION)

REV.	DATE	DESCRIPTION	BY
10/2/14		Updated Vicinity Map and Number of Sheets	LMH



COASTAL PROTECTION & RESTORATION AUTHORITY
 OPERATIONS DIVISION
 450 LAUREL STREET
 BATON ROUGE, LOUISIANA 70801

DRAWN BY: LMH

DESIGNED BY: LMH

Cote Blanche Hydrologic Restoration/
 School Bus Bayou Project - Wall Extension

STATE PROJECT NUMBER: TV-04

FEDERAL PROJECT NUMBER:

APPROVED BY: GJL

Title Sheet

DATE: June 2014

SHEET 1 OF 9

General Notes

- All elevations are given in the North American Vertical Datum of 1988 (NAVD 88) U.S. Survey Feet (Feet). All horizontal coordinates are given in the North American Datum of 1983 (NAD83, Louisiana State Plane South Zone U.S. Feet), GEOID Model 12A.
- The contractor shall be responsible for navigating from a navigable water body to the site. The contractor shall also be responsible for navigating within the limits of the project site. The project engineer or inspector shall monitor equipment operations during construction.
- All equipment shall be floating at all times during transit to and from the project site.
- The contractor shall be responsible for notifying all utility and pipeline companies identified in the specifications at least five (5) working days prior to mobilization. All underground pipelines and utilities shall be marked with buoys by the contractor. The contractor shall maintain buoys during construction. It is the responsibility of the contractor to maintain the clearances from the pipelines set forth in the plan drawings or in the bid documents. No excavation is allowed within any area restricted by the pipeline companies and set forth on the plans. Pipeline locations shown on the plans are approximations. The owner is not liable for exact locations. The contractor must call Louisiana One Call at 1-800-272-3020 at least 5 working days prior to mobilization.
- The plans and bid documents are complementary; what is required in one is as binding as if required by all. Clarifications, interpretations, or notifications of minor variations and deviations in the contract documents will be issued by the project engineer, if necessary.
- Any damage to existing U.S. Coast Guard Navigation Aids or Private Navigation Aids shall be repaired by the contractor to U.S. Coast Guard Standards at the expense of the contractor.
- The contractor shall not, at any time, tread on existing marsh or vegetated wetlands unless otherwise directed by the project engineer.
- Quantities shown are for bidding purposes only and were calculated based on design.
- The design location of the proposed wall extension is based on the May 2013 survey conducted by Providence GSE.

Summary of Estimated Quantities

BASE BID			
ITEM No.	ITEM	UNIT	QTY
TS-101	Mobilization and Demobilization	Lump Sum	1
TS-301	Treated Timber Piles	EA	206
TS-401	20' Vinyl Sheet Pile	EA	1,264
TS-401	16' Vinyl Sheet Pile	EA	136
TS-501	Wooden Walers	LN FT	2,800
TS-601	Waler Splice Plate	EA	280
TS-601	Splice Plate Bolts	EA	560
TS-601	5" Bolt	EA	2,528
TS-601	36" Pile Bolt	EA	410
TS-601	18" Waler Bolt	EA	200
TS-701	Rock Relocation	Lump Sum	1
TS-801	Permanent Warning Signs	EA	2
TS-901	Railings, Pillings, and Sign Replacement	Lump Sum	1

ADDITIVE ALTERNATE 1			
ITEM No.	ITEM	UNIT	QTY
TS-301	Treated Timber Piles	EA	29
TS-401	20' Vinyl Sheet Pile	EA	180
TS-401	16' Vinyl Sheet Pile	EA	20
TS-501	Wooden Walers	LN FT	400
TS-601	Waler Splice Plate	EA	44
TS-601	Splice Plate Bolts	EA	88
TS-601	5" Bolt	EA	360
TS-601	36" Pile Bolt	EA	58
TS-601	18" Waler Bolt	EA	28

ADDITIVE ALTERNATE 2			
ITEM No.	ITEM	UNIT	QTY
TS-301	Treated Timber Piles	EA	25
TS-401	20' Vinyl Sheet Pile	EA	154
TS-401	16' Vinyl Sheet Pile	EA	16
TS-501	Wooden Walers	LN FT	340
TS-601	Waler Splice Plate	EA	40
TS-601	Splice Plate Bolts	EA	80
TS-601	5" Bolt	EA	308
TS-601	36" Pile Bolt	EA	50
TS-601	18" Waler Bolt	EA	24

ADDITIVE ALTERNATE 3			
ITEM No.	ITEM	UNIT	QTY
TS-301	Treated Timber Piles	EA	29
TS-401	20' Vinyl Sheet Pile	EA	180
TS-401	16' Vinyl Sheet Pile	EA	20
TS-501	Wooden Walers	LN FT	400
TS-601	Waler Splice Plate	EA	44
TS-601	Splice Plate Bolts	EA	88
TS-601	5" Bolt	EA	360
TS-601	36" Pile Bolt	EA	58
TS-601	18" Waler Bolt	EA	28
TS-801	Permanent Warning Signs	EA	1

Horizontal and Vertical Control Information

Horizontal Datum: Adjusted NAD 83 Datum LSZ (1702) Ft

Vertical Datum: Adjusted NAVD 88

GEOID Model Used: GEOID99 Hgt: -25.625 mtrs

Reference Benchmarks:

- TV04-SM-01
- N: 414,937.84
- E: 3,200,880.61
- Elevation +3.57' NAVD 88 (1.089 mtrs)

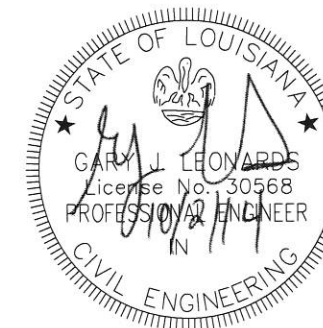

REV.	DATE	DESCRIPTION	BY
1	10/2/14	Updated Quantities and Number of Sheets	LMH



COASTAL PROTECTION & RESTORATION AUTHORITY
OPERATIONS DIVISION

450 LAUREL STREET
BATON ROUGE, LOUISIANA 70801

DRAWN BY: LMH

DESIGNED BY: LMH

Cote Blanche Hydrologic Restoration/
School Bus Bayou Project - Wall Extension

STATE PROJECT NUMBER: TV-04

FEDERAL PROJECT NUMBER:

APPROVED BY: GJL

General Notes

DATE: June 2014

SHEET 2 OF 9

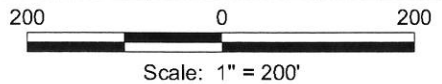
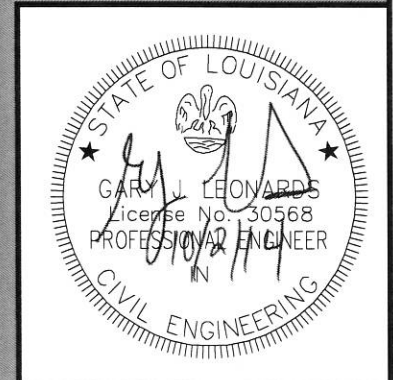
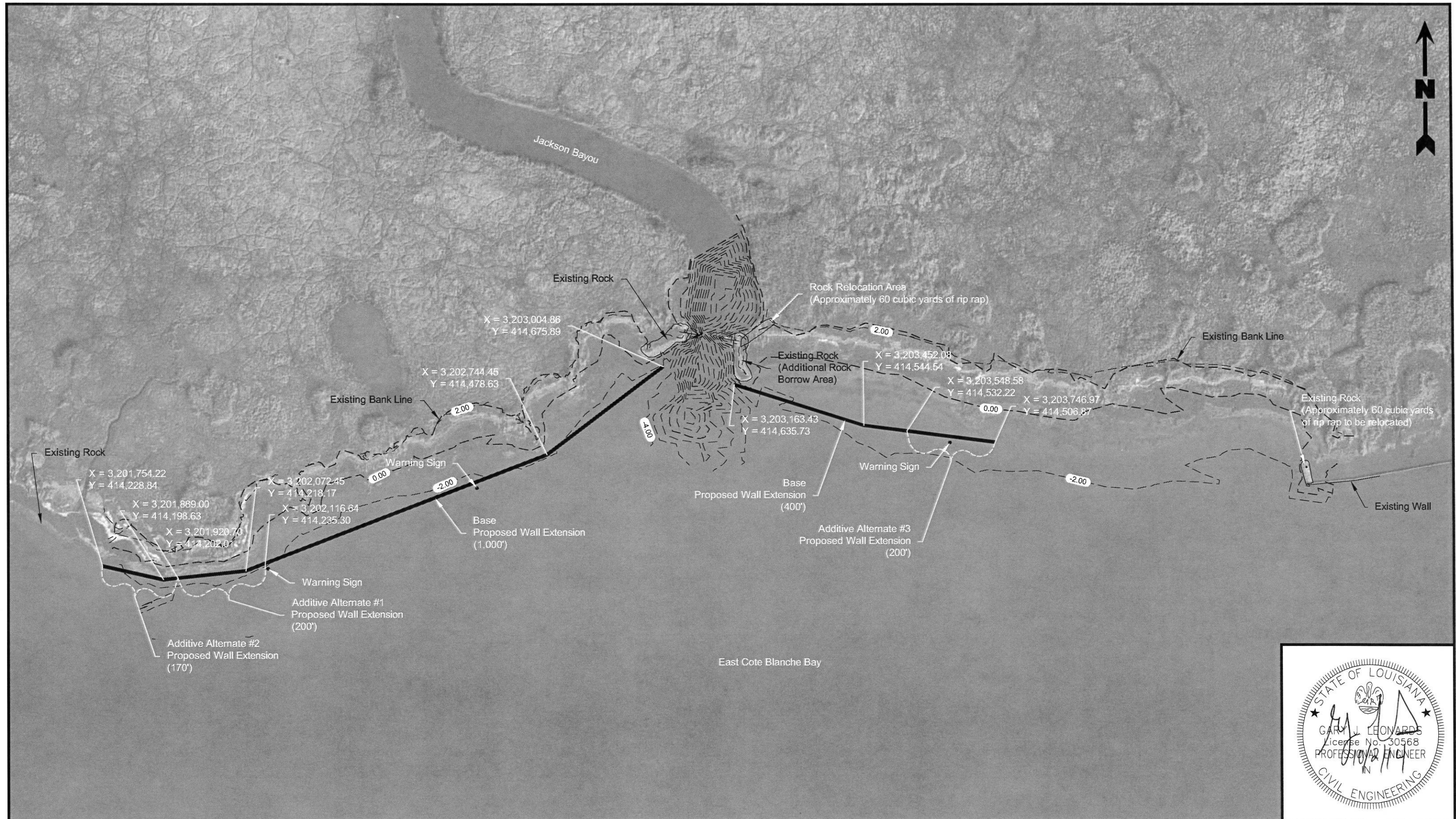

Reference
Base map comprised of ESRI World Imagery exported 10/02/14.

REV.	DATE	DESCRIPTION	BY
1	10/2/14	Updated Rock Borrow, Aerial and Number of Sheets	LMH



COASTAL PROTECTION & RESTORATION AUTHORITY
OPERATIONS DIVISION
450 LAUREL STREET
BATON ROUGE, LOUISIANA 70801
DRAWN BY: LMH DESIGNED BY: LMH

Cote Blanche Hydrologic Restoration/
School Bus Bayou Project - Wall Extension
STATE PROJECT NUMBER: TV-04
FEDERAL PROJECT NUMBER:
APPROVED BY: GJL

Plan View
DATE: June 2014
SHEET 3 OF 9

Drawing No.: 621-001-001-B021
Providence Engineering and Environmental Group LLC

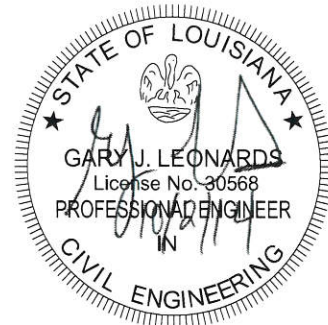
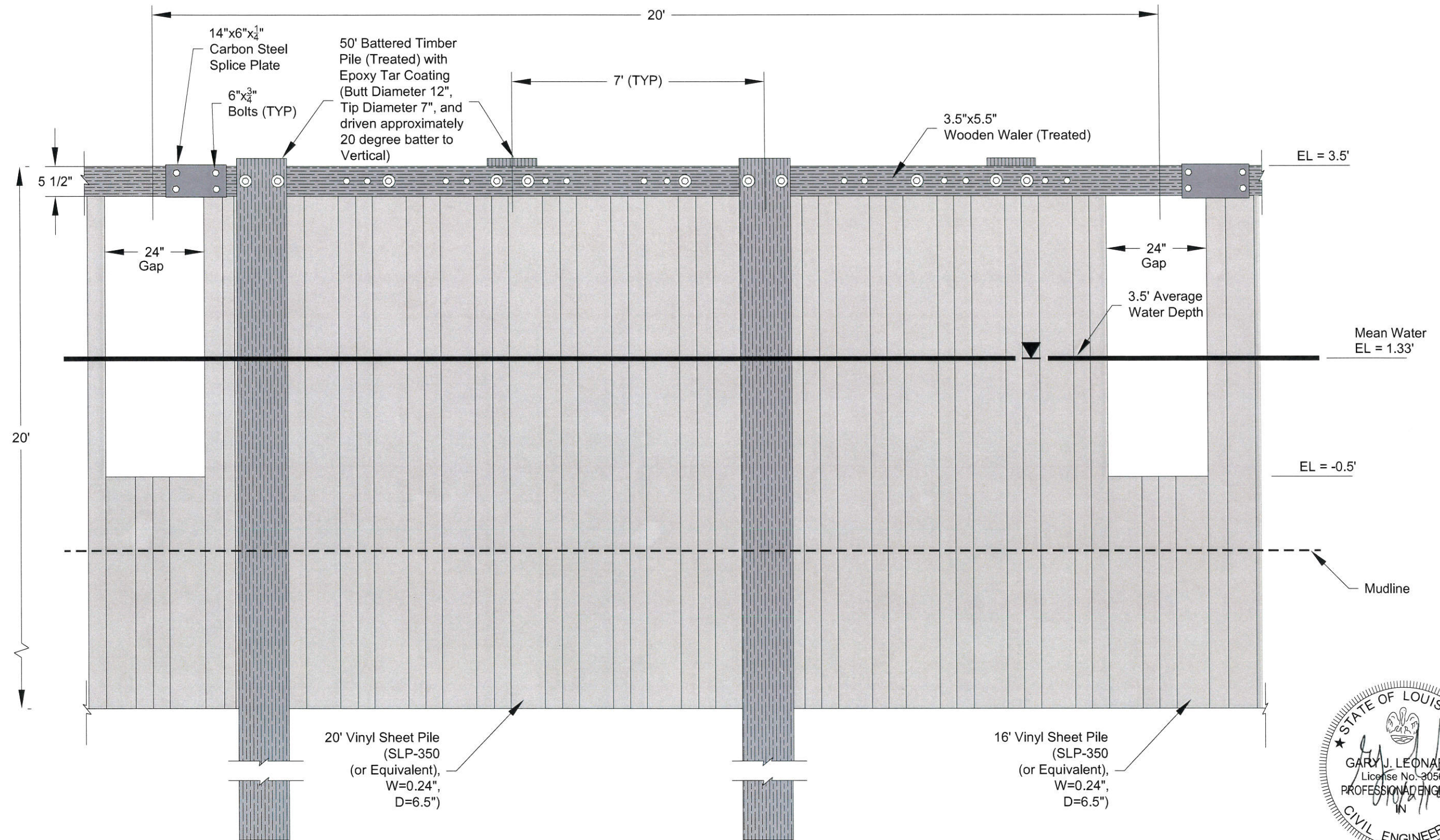

Notes

1. Mean water elevation derived from Coastwide Reference Monitoring System (CRM) water level elevations.
2. Ground surface elevation is approximately -2.0'.
3. Mean low water is 0.08', mean water is 1.27', and mean high water is 2.28'

REV.	DATE	DESCRIPTION	BY
10/2/14		Updated Number of Sheets	LMH



COASTAL PROTECTION & RESTORATION AUTHORITY
OPERATIONS DIVISION

450 LAUREL STREET
BATON ROUGE, LOUISIANA 70801

DRAWN BY: LMH

DESIGNED BY: LMH

Cote Blanche Hydrologic Restoration/
School Bus Bayou Project - Wall Extension

STATE PROJECT NUMBER: TV-04

FEDERAL PROJECT NUMBER:

APPROVED BY: GJL

Details

DATE: June 2014

SHEET 4 OF 9

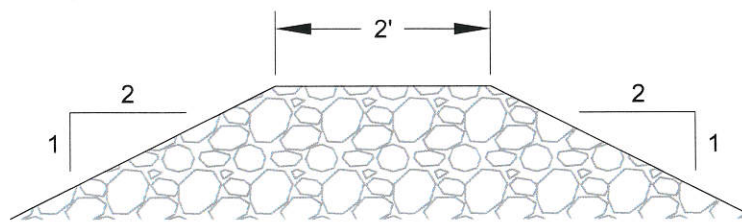
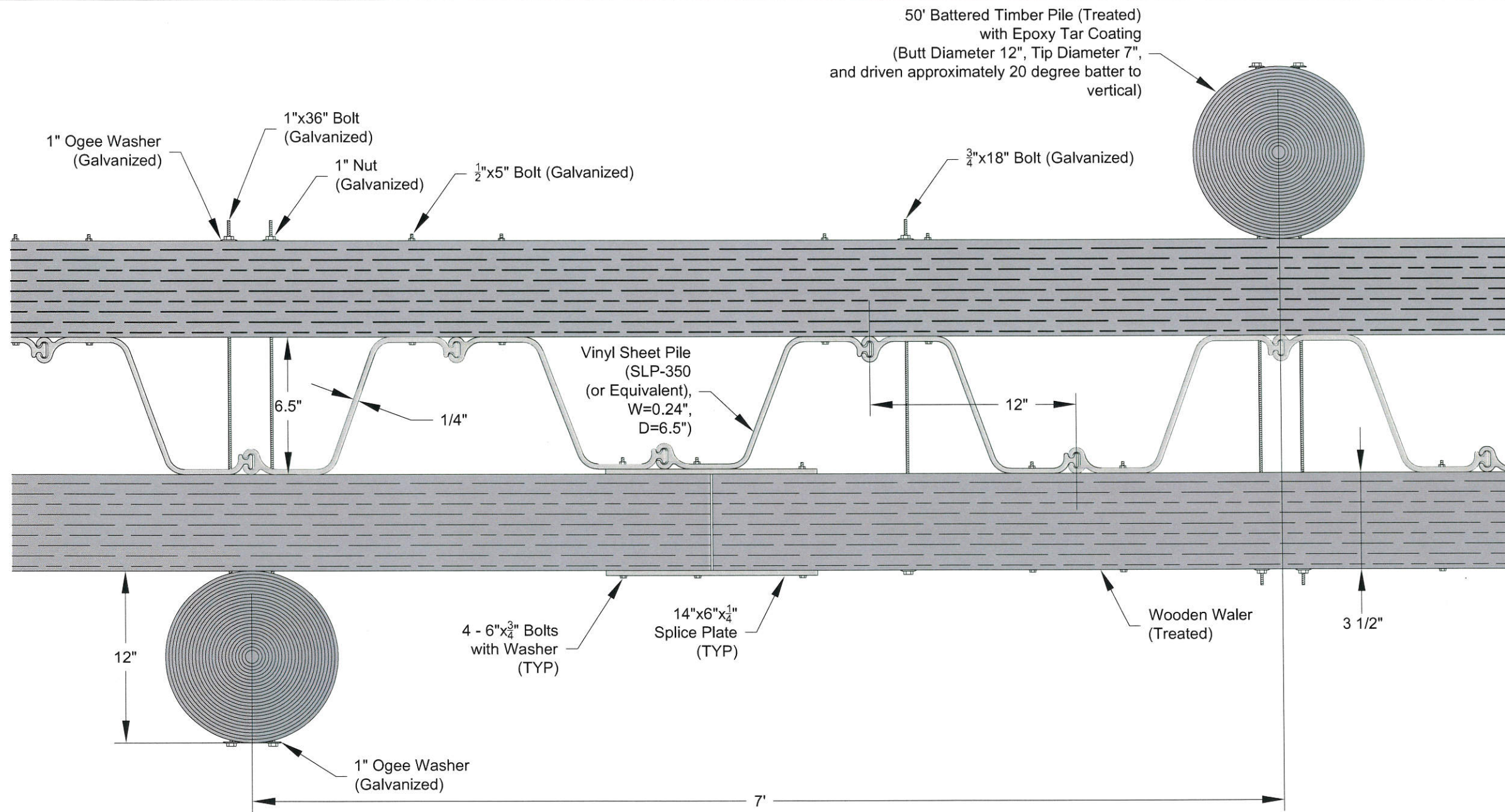

Rock Relocation Area Detail
(Field Fit)

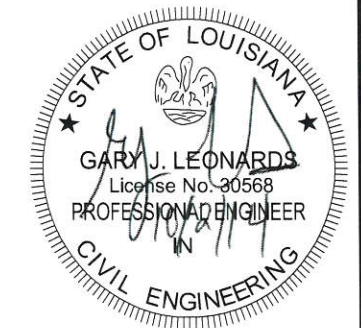

REV.	DATE	DESCRIPTION	BY
1	10/2/14	Updated Number of Sheets	LMH



COASTAL PROTECTION & RESTORATION AUTHORITY
OPERATIONS DIVISION
 450 LAUREL STREET
 BATON ROUGE, LOUISIANA 70801

DRAWN BY: LMH DESIGNED BY: LMH

Cote Blanche Hydrologic Restoration/
 School Bus Bayou Project - Wall Extension

STATE PROJECT NUMBER: TV-04
 FEDERAL PROJECT NUMBER:

APPROVED BY: GJL

Details

DATE: June 2014
 SHEET 5 OF 9

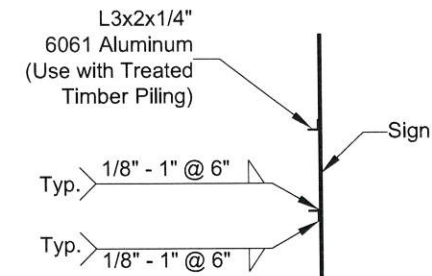
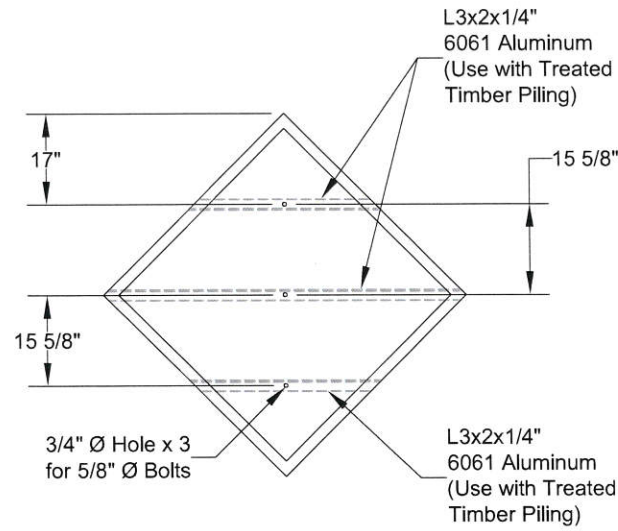
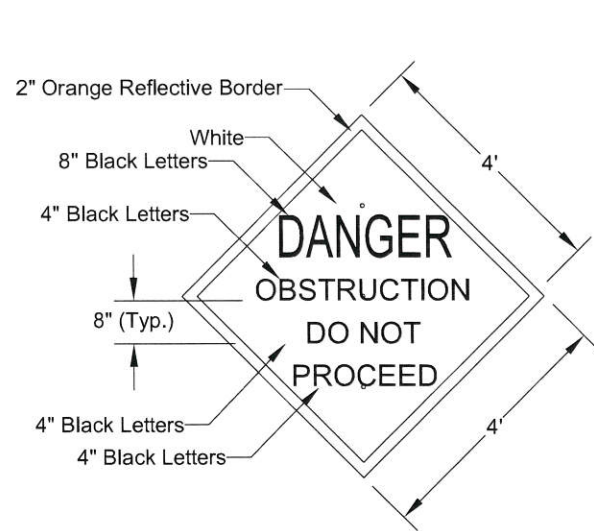

Warning Sign Detail

Not to Scale

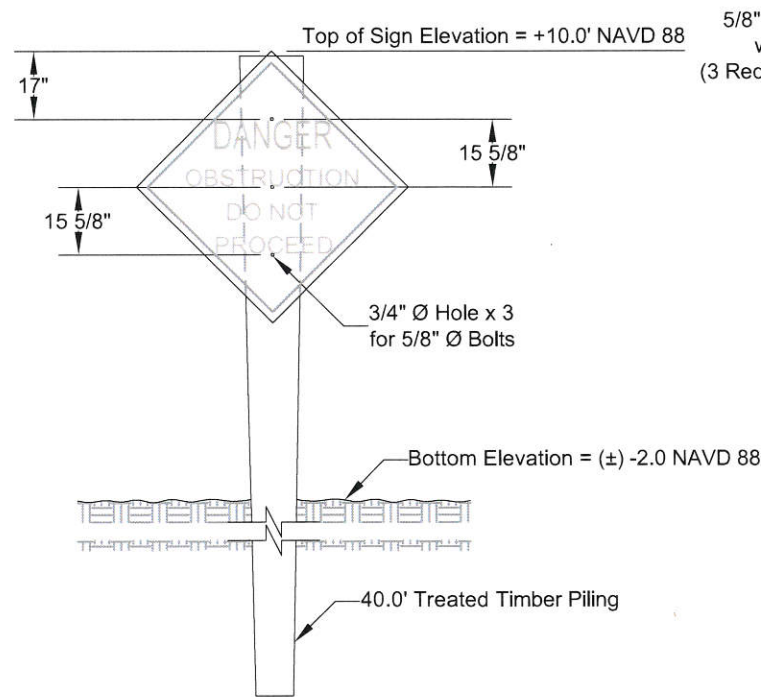

Warning Sign Elevation

Not to Scale

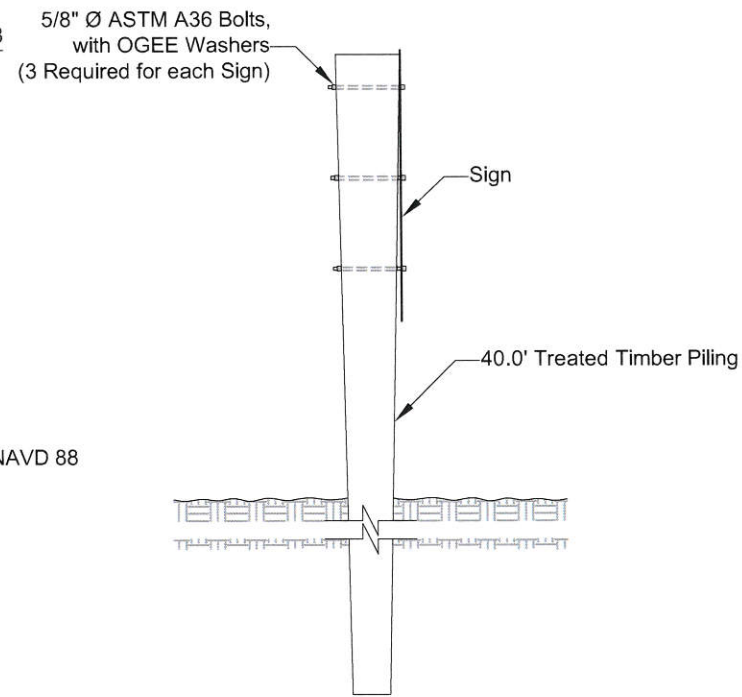

Warning Sign Side Detail

Not to Scale

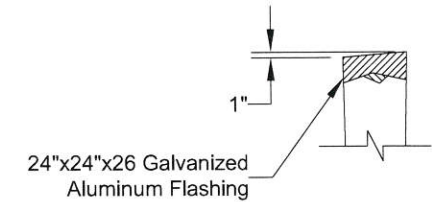

Typical Pile Cap

Not to Scale

Note

Signs shall be placed 5.0' off the front toe of the wall.

REV.	DATE	DESCRIPTION	BY
1	10/2/14	Updated Number of Sheets	LMH



COASTAL PROTECTION & RESTORATION AUTHORITY
OPERATIONS DIVISION

450 LAUREL STREET
BATON ROUGE, LOUISIANA 70801

DRAWN BY: LMH

DESIGNED BY: LMH

Cote Blanche Hydrologic Restoration/
School Bus Bayou Project - Wall Extension

STATE PROJECT NUMBER: TV-04

FEDERAL PROJECT NUMBER:

APPROVED BY: GJL

Warning Sign Details

DATE: June 2014

SHEET 6 OF 9

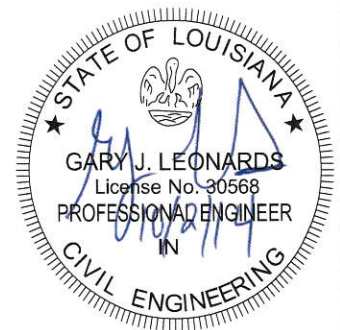

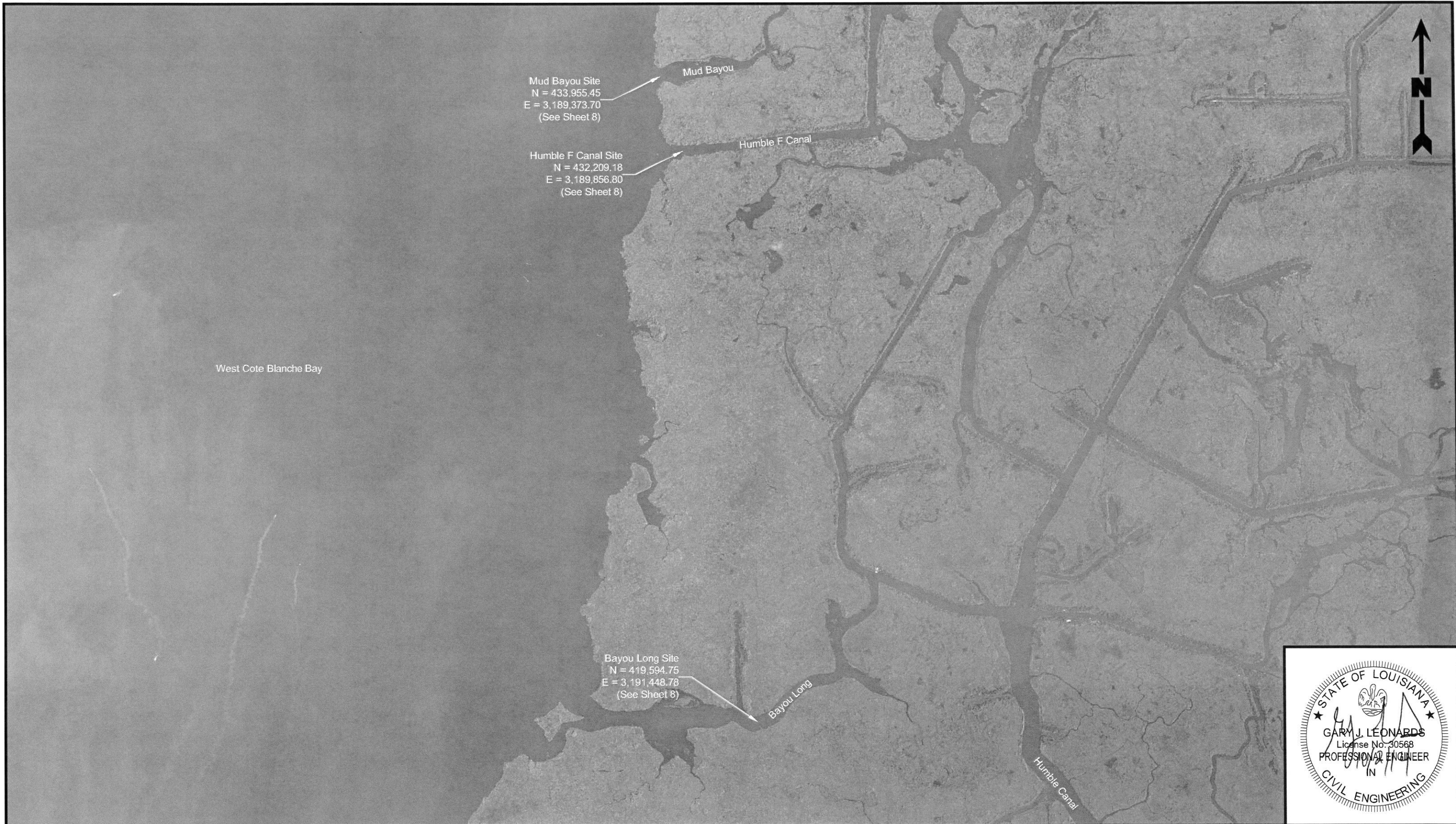

West Cote Blanche Bay

Mud Bayou Site
N = 433,955.45
E = 3,189,373.70
(See Sheet 8)

Humble F Canal Site
N = 432,209.18
E = 3,189,856.80
(See Sheet 8)

Bayou Long Site
N = 419,594.75
E = 3,191,448.78
(See Sheet 8)

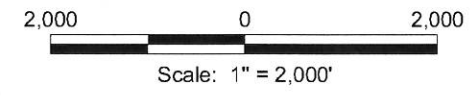
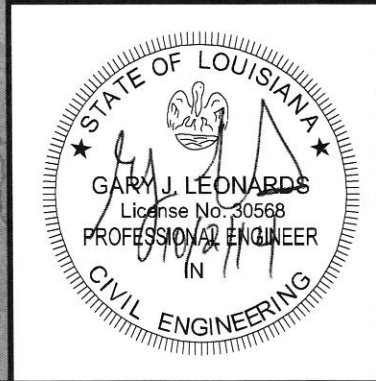

Reference

Base map comprised of 2013 aerial photograph.

REV.	DATE	DESCRIPTION	BY



COASTAL PROTECTION & RESTORATION AUTHORITY
OPERATIONS DIVISION
450 LAUREL STREET
BATON ROUGE, LOUISIANA 70801

DRAWN BY: LMH

DESIGNED BY: LMH

Cote Blanche Hydrologic Restoration/
School Bus Bayou Project - Wall Extension

STATE PROJECT NUMBER: TV-04

FEDERAL PROJECT NUMBER:

APPROVED BY: GJL

Sign Placement and Railing
Overall Plan View

DATE: October 2014

SHEET 7 OF 9

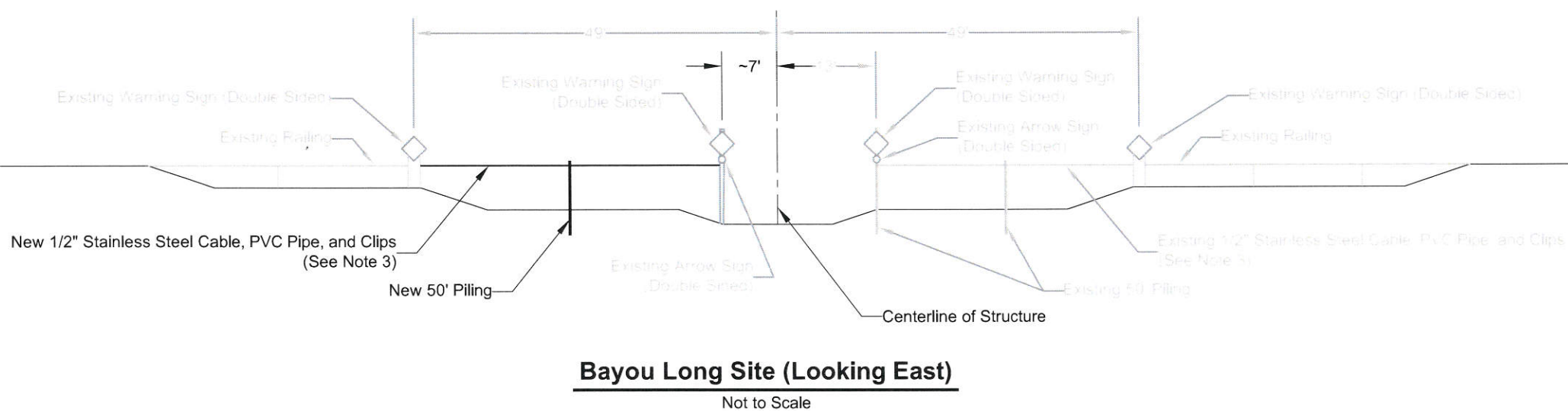
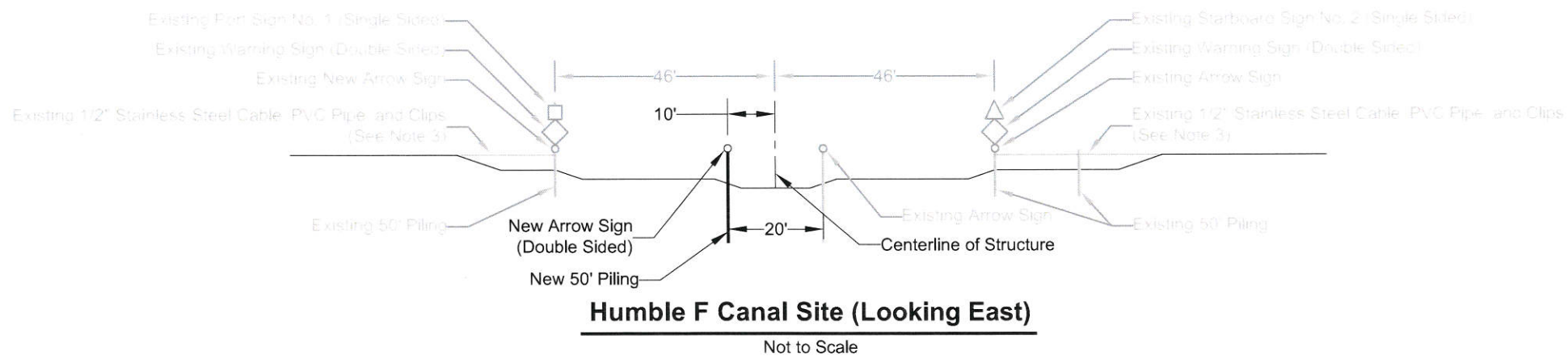
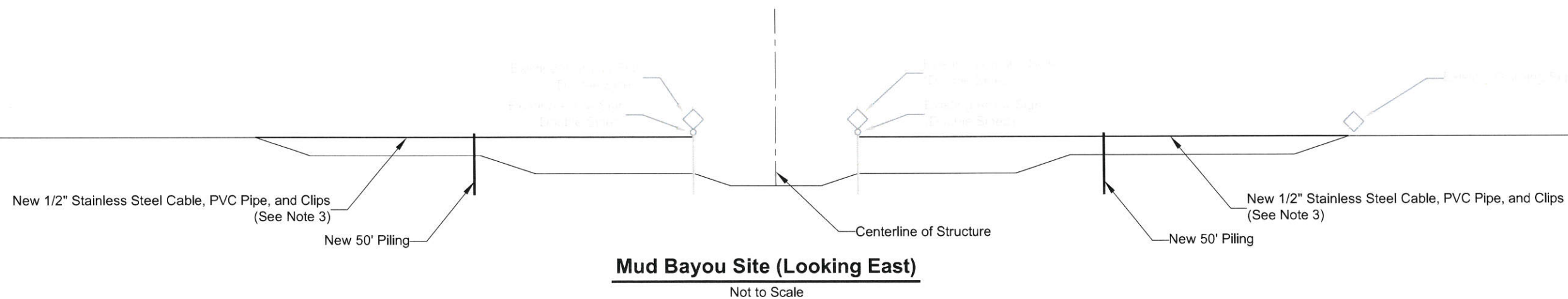

Notes

1. Sheet piling and fill material not shown for clarity.
2. Pile cap is continuous to wing-wall. Covering the entire wing-wall.
3. Stainless Steel Cable is at a constant elevation, consistent with the elevation at the intersection of railing and pile cap.

REV.	DATE	DESCRIPTION	BY



COASTAL PROTECTION & RESTORATION AUTHORITY
OPERATIONS DIVISION

450 LAUREL STREET
BATON ROUGE, LOUISIANA 70801

DRAWN BY: LMH

DESIGNED BY: LMH

Cote Blanche Hydrologic Restoration/
School Bus Bayou Project - Wall Extension

STATE PROJECT NUMBER: TV-04

FEDERAL PROJECT NUMBER:

APPROVED BY: GJL

Sign and Railing Placement

DATE: October 2014

SHEET 8 OF 9

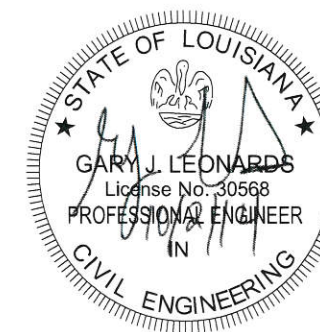

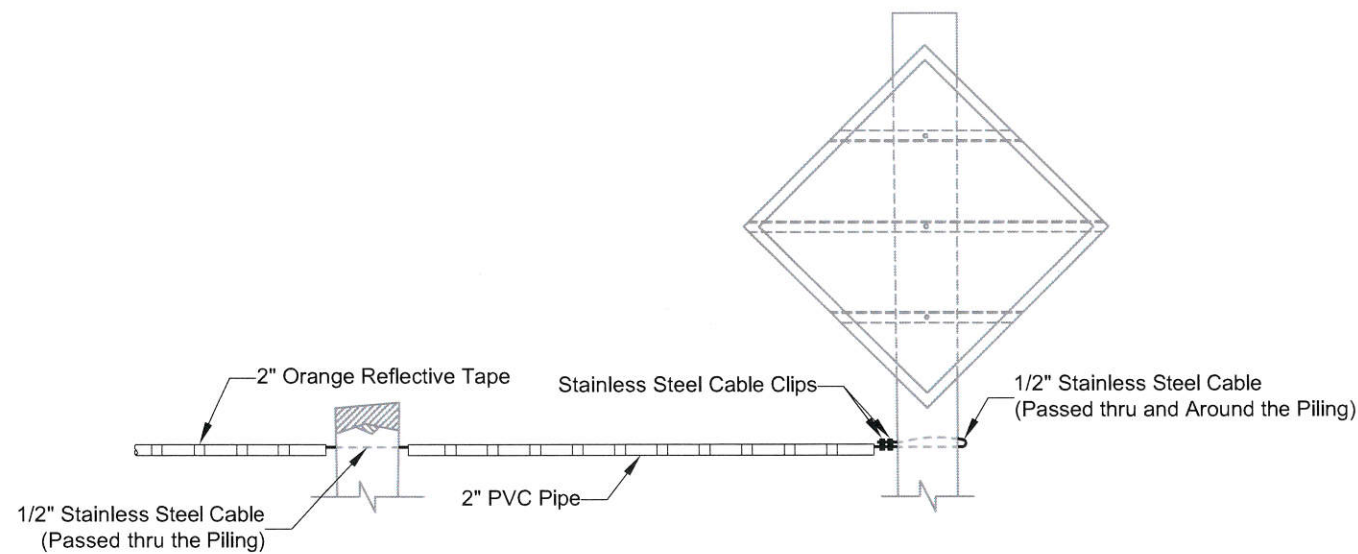

Cable and PVC Pipe Detail

Not to Scale

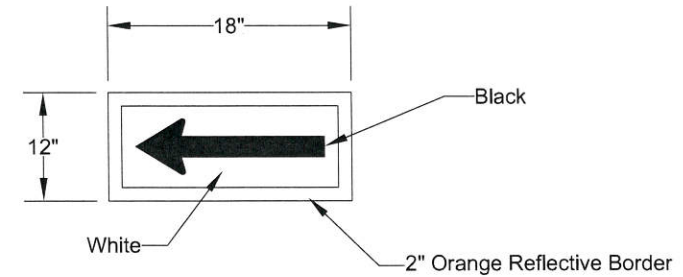

Arrow Sign Detail

Not to Scale

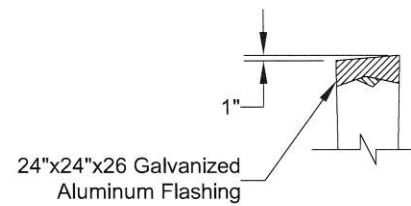

Typical Pile Cap

Not to Scale

Notes

1. Reference herein to the "Standard Specifications" refer to the "LA Standard Specifications for Roads and Bridges", as published by the Louisiana Department of Transportation and Development, latest edition.
2. Neoprene washers were placed between the sign and the piling at all points of contact.
3. Hardware for timber connections were hot dip galvanized in accordance with section 811.5 of the Louisiana Standard Specifications.
4. Timber piles were preserved and conform to sections 804 and 1014 of the Louisiana Standard Specifications.
5. The top of the piles were coated with coal tar epoxy paint prior to placing cap. The pile cap was attached using aluminum or stainless steel nails.
6. Timber piling was 50.0' in length with a 12" diameter butt and 8" diameter at the tip.
7. Exposed bolt threads were either tack welded to nuts, stripped, or damaged by other approved method to prevent easy removal.
8. Stainless steel cable is at a constant elevation, consistent with the elevation at the intersection of stainless steel cable and pile cap.

REV.	DATE	DESCRIPTION	BY



COASTAL PROTECTION & RESTORATION AUTHORITY
OPERATIONS DIVISION

450 LAUREL STREET
BATON ROUGE, LOUISIANA 70801

DRAWN BY: LMH

DESIGNED BY: LMH

Cote Blanche Hydrologic Restoration/
School Bus Bayou Project - Wall Extension

STATE PROJECT NUMBER: TV-04

FEDERAL PROJECT NUMBER:

APPROVED BY: GJL

Detail Sheet

DATE: October 2014

SHEET 9 OF 9

